

# Personalize your frame

New polychromic & 3D effects for  
small and big collections

**NEW**  
with no tooling charge



# Personalize your frame

New polychromic & 3D effects for  
small and big collections

---

ND26

New Hot Stamping of LOGO

---

NDE120 · NDE123

New Ink printing of LOGO on Hot Stamping

---

NDE30 · NDE33

DOUBLE EFFECT personalization

---

MEDICAL SILICONE NOSE PADS

The COMFORT side of design



## ND26

New Hot Stamping of LOGO

### EXCELLENT DEFINITION

by transparency



---

#### ND26 PERSONALIZATION

The excellent definition is obtained by contrast between the matt background and the transparency of the logo.  
The background is available in matt silver and in matt gold.

---

## INSERT AND LOGO

The personalization is offered on our plastic insert in standard "C" Shape

The logo can be oriented or not oriented

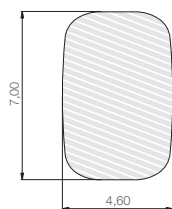

PERSONALIZATION AREA OF  
**STANDARD INSERT "C" SHAPE**

---

## ASSEMBLING SYSTEM

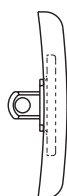

**SCREW SYSTEM**

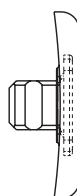

**CLICK SYSTEM**

---

## COMBINATIONS AVAILABLE

ND26	
Background	Logo
MATT GOLD	TRANSPARENT
MATT SILVER	TRANSPARENT

---

## PAD SHAPE AND MATERIALS

This personalization is available on all VisotticaComotec  
MPM Medical PVC Pads with Plastic Inserts



---

**No tooling charge, low minimum quantity, samples available in a few days**

---



## NDE120 - NDE123

New Ink printing of LOGO on Hot Stamping

### CROMATIC LOGO

on metallic effect background



---

#### NDE120 - NDE123 PERSONALIZATION

The cromatic logo is obtained by precision ink printing on a metallic effect hot stamped background that covers the complete surface of the insert. The logo can be printed in many different ink colors (red, black, gray, blue, green). The background is available in matt silver and in matt gold.

---

## INSERT AND LOGO

The personalization is offered on our plastic insert in standard "C" Shape

The logo can be oriented or not oriented

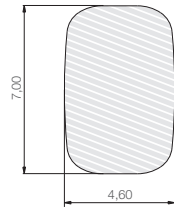

PERSONALIZATION AREA OF  
**STANDARD INSERT "C" SHAPE**

---

## ASSEMBLING SYSTEM

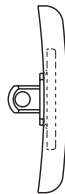

**SCREW SYSTEM**

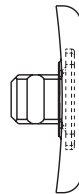

**CLICK SYSTEM**

---

## COMBINATIONS AVAILABLE

<b>NDE120</b>	
Background	Logo
MATT GOLD	Red, Black, Gray, Blue, Green
MATT SILVER	Red, Black, Gray, Blue, Green

<b>NDE123</b>	
Background	Logo
SHINY GOLD	Red, Black, Gray, Blue, Green
SHINY SILVER	Red, Black, Gray, Blue, Green

---

## PAD SHAPE AND MATERIALS

This personalization is available on all VisotticaComotec  
MPM Medical PVC Pads with Plastic Inserts



---

**No tooling charge, low minimum quantity, samples available in a few days**

---



## **NDE30 - NDE33**

DOUBLE EFFECT personalization

### **HIGH CONTRAST LOGO**

Combining Matt and Shiny with Gold and Silver colors



---

### **NDE30 - NDE33 PERSONALIZATION**

The double effect is obtained by contrast between shiny metal foil background and matt logo, or matt background and shiny logo. The usage of Gold and Silver in different combinations sharpens the contrast and gives a luxury metallic effect.



---

## INSERT AND LOGO

The personalization is offered on our plastic insert in standard "C" Shape

The logo can be oriented or not oriented

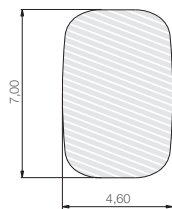

PERSONALIZATION AREA OF  
**STANDARD INSERT "C" SHAPE**

---

## ASSEMBLING SYSTEM

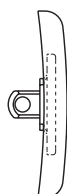

**SCREW SYSTEM**

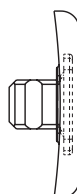

**CLICK SYSTEM**

---

## COMBINATIONS AVAILABLE

NDE30	
Background	Logo
MATT GOLD	SHINY GOLD
MATT GOLD	SHINY SILVER
MATT SILVER	SHINY GOLD
MATT SILVER	SHINY SILVER

NDE33	
Background	Logo
SHINY GOLD	MATT GOLD
SHINY GOLD	MATT SILVER
SHINY SILVER	MATT GOLD
SHINY SILVER	MATT SILVER

---

## PAD SHAPE AND MATERIALS

This personalization is available on all VisotticaComotec  
MPM Medical PVC Pads with Plastic Inserts



---

**No tooling charge, low minimum quantity, samples available in a few days**

---



# MEDICAL SILICONE NOSE PADS

The comfort side of design

**NO INSERT**

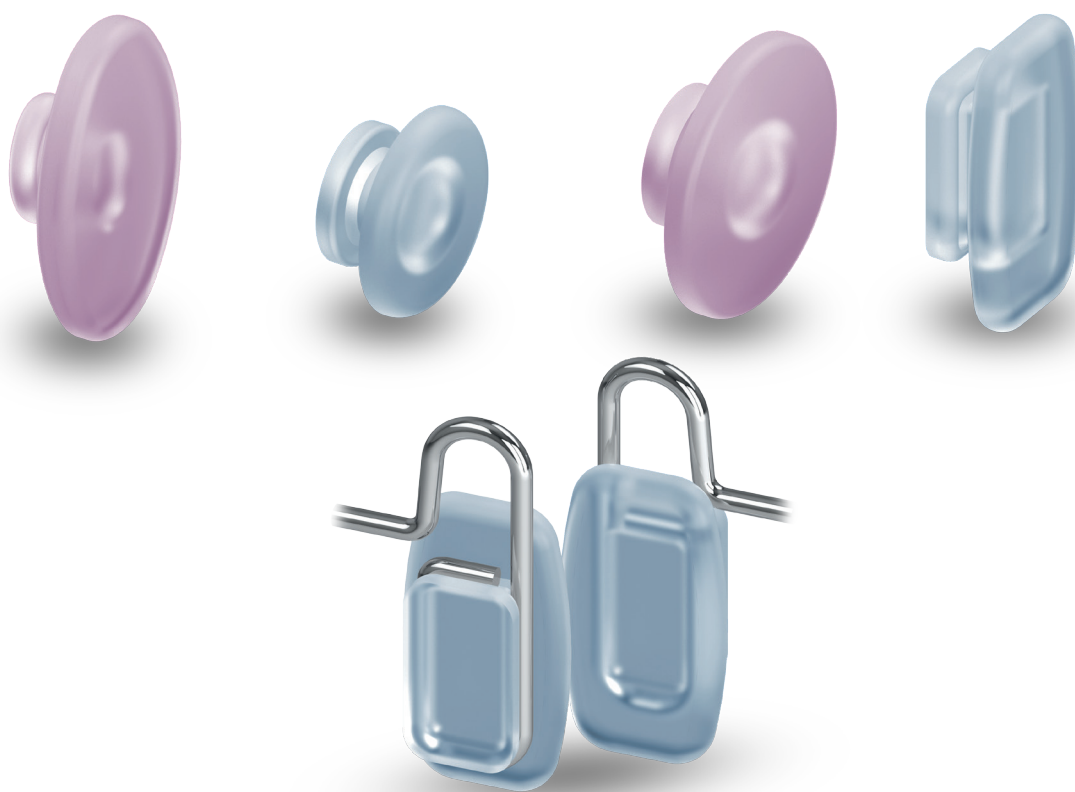

---

## MEDICAL SILICONE

The softness and flexibility of the silicone material assures a very comfortable fit.

### MAIN BENEFIT AND FEATURES

- Flexibility and Adaptability
- Smooth and soft material
  - Anti-sliding effect
- Skin friendly, anti-allergic, bio-compatible
  - Long lasting

## AVAILABLE COLORS

On request, silicone nose pads are available in crystal clear, transparent and more colorful tone like yellow, red and green.

## AVAILABLE SHAPES WITH BUTTON SYSTEM

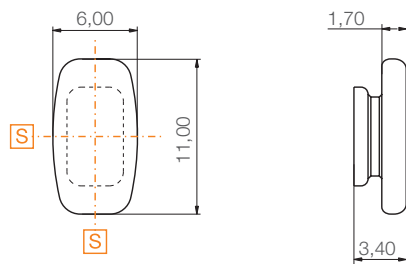

<b>BUTTON System</b>	<b>CODE</b>	<b>73NP93151000</b>
	OLD ref.	ZD1008/3

MATT TRANSPARENT

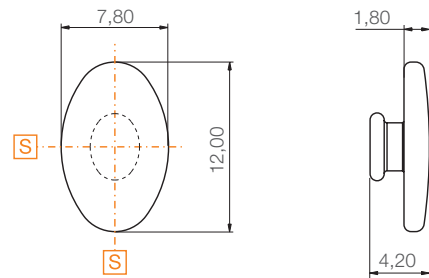

<b>BUTTON System</b>	<b>CODE</b>	<b>73NP93145000</b>
	OLD ref.	ZD1110/3

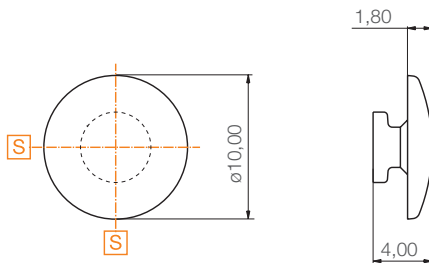

<b>BUTTON System</b>	<b>CODE</b>	<b>73NP91259000</b>
	OLD ref.	ZD0051/3

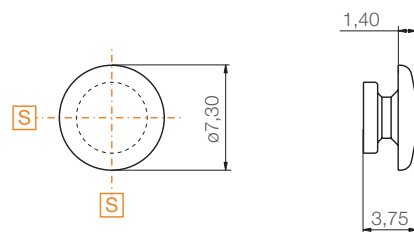

<b>BUTTON System</b>	<b>CODE</b>	<b>73NP91511000</b>
	OLD ref.	ZD0066/3

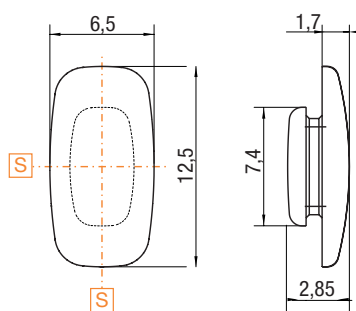

<b>BUTTON System</b>	<b>CODE</b>	<b>73NPB0956A1WYX</b>
	Shape	B-2664

MATT TRANSPARENT

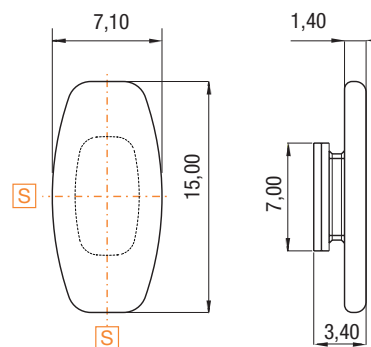

<b>BUTTON System</b>	<b>CODE</b>	<b>73NPB0955A1WYX</b>
	Shape	B-2553

MATT TRANSPARENT

**Visottica Industrie S.p.a.**  
Via Vecchia Trevigiana, 11  
31058 Susegana  
(Treviso), Italy  
Tel +39 0438 6551  
fax +39 0438 450 855  
sales@visotticacomotec.com

**O'Reilly Industrial Ltd.**  
Rm 302, Shui Hing Centre,  
13 Sheung Yuet Road,  
Kowloon Bay, Kowloon, Hong Kong  
Tel. +852 2796 6010  
Fax +852 2796 4631  
sales@visotticacomotec.hk

**COMOTEC Optical Products (Dongguan) Ltd.**  
No. 20, Weijian Road  
Weijian Industrial Park  
ChaShan Town, Dongguan City  
Guangdong Province, China 523380  
Tel. +86 769 8233 9955  
Fax +86 769 8233 9977